



## 61 Lorimer Street, Llanarth FOR SALE

### Elevated Escape

Proudly presenting to the market, a beautifully presented family home that delivers on space and quality interiors. With immaculately landscaped grounds and an elegant facade, this property must be seen to fully appreciate its grand scale appeal. With outdoor space that seems to beckon; from the copious amounts of useful & ornamental garden space, serene leafy outlook from every window, sunny elevated position and sweeping district views, this home is the epitome of relaxed family living and will more than exceed your expectations.

Property features include:

- A generous master bedroom with ensuite & walk in robe and three additional bedrooms all with built-in robes
- A centrally placed kitchen, delightful sunny breakfast nook & a large living and dining space off the kitchen that opens out to a special one of a kind enclosed entertainers paradise, with a dining area and luxurious swim spa.
- Large L-shaped formal lounge which extends around to an additional music/library space
- A spacious three-way main bathroom & great-sized laundry, fantastic under house workshop and double lock-up garage
- Fabulous outdoor space with beautifully maintained and established lawns, raised gardens, excellent curb appeal & all set on a generous 1077m2 block

### Features

- 2 Toilets
- Alarm System
- Built-In Robes
- Dishwasher
- 1 Ensuite
- 2 Living Areas
- Pet Friendly
- Fully Fenced
- Inground Pool
- Outside Spa
- Patio
- Remote Garage Door
- Secure Parking
- Air Conditioning
- Gas Heating



**Sandy Fairbrother**

Principal - Cleary Fairbrother Property

**M:** 0438 436 161

**E:** sandy.fairbrother@smileelite.com



**Jay Cleary**

Principal - Cleary Fairbrother Property

**M:** 0439 891 872

**E:** jay.cleary@smileelite.com

Split System A/C

**Land size**

1,077.00 Sqm

**Council rates**

\$783 per qtr



**Sandy Fairbrother**

Principal - Cleary Fairbrother Property

**M:** 0438 436 161

**E:** [sandy.fairbrother@smileelite.com](mailto:sandy.fairbrother@smileelite.com)



**Jay Cleary**

Principal - Cleary Fairbrother Property

**M:** 0439 891 872

**E:** [jay.cleary@smileelite.com](mailto:jay.cleary@smileelite.com)

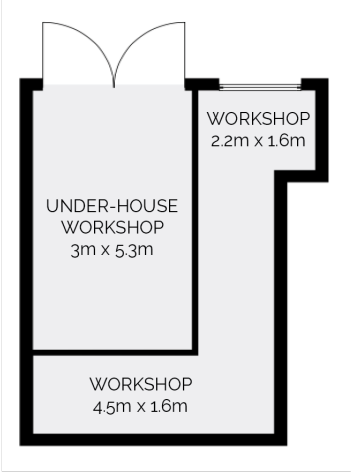
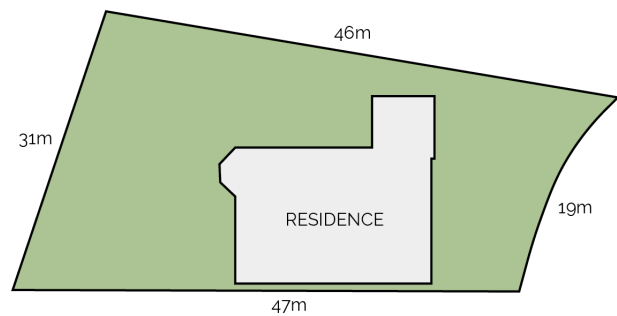

APPROX. TOTAL 1,075m²



Scale in metres. Dimensions are approximate. All information contained herein is gathered from sources we believe to be reliable, however we cannot guarantee its accuracy and interested persons should rely on their own enquiries.