



3 Minkara Road, BAYVIEW FOR SALE



4.7 acres of exciting capital potential in high-end neighbourhood and only 1km to Pittwater / 4km to Mona Vale Beach / 30km to CBD

3 Minkara Road presents the perfect opportunity to secure a prime piece of real estate in the prestigious suburb of Bayview - 1km to Pittwater / 4km to Mona Vale Beach / 30km to CBD

Surrounded by lush greenery with ocean glimpses, this property provides a tranquil and private environment. With two street frontages and a gently sloping block, there is ample space for a multitude of uses.

The choice is yours - whether it be a family home, a weekend-er with extensive gardens or space for the animals. Choose one or all as there is plenty of room on this stunning 5-acre block.

Whilst dreaming of and planning your future move into the 1000 sqm, 5 bed, 3 bath home with extensive living areas, pool and numerous other features and enjoy your environment. With the perfect blend of shared and private spaces, it is ideal for multigenerational families.

This home is a bonus on this magnificent block representing amazing value.

The established equestrian facilities offer stables, paddocks and a round yard and can be further improved to your taste. Unlock the amazing possibilities of this spectacular block offering endless potential. Enjoy the country's coastal lifestyle with easy access to beaches, and golf courses, 1.2 km to Pittwater and 35 mins to CBD.

With a committed seller now is the time to capitalize on this opportunity. Call now for a private viewing.

Features

Land size

4.72 Ac



Shayne Hutton

Co-Founder/Principal - Sales Lead

M: 0400 420 000

E: shayne@sydneycountryliving.com.au



Shayne Hutton

Co-Founder/Principal - Sales Lead

M: 0400 420 000

E: shayne@sydneycountryliving.com.au

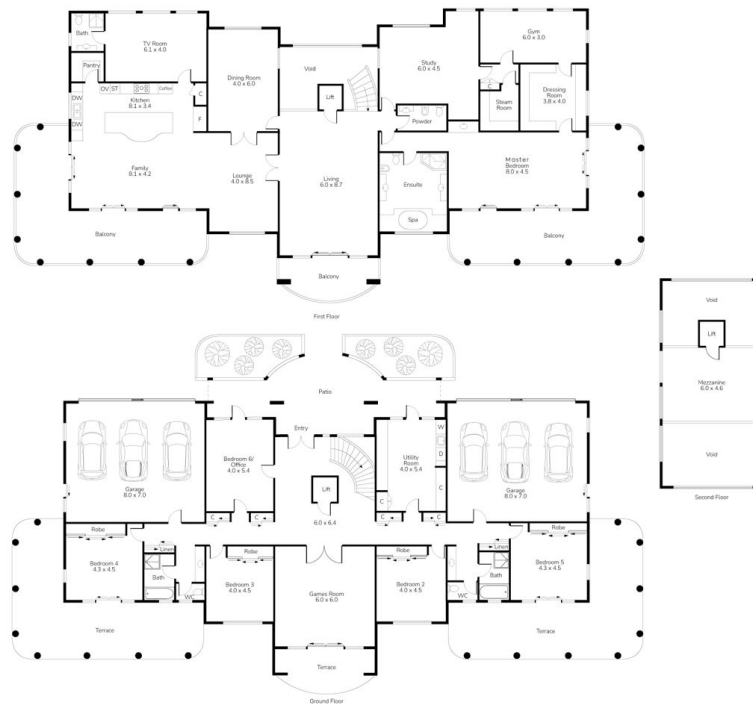

INT: 770 m²
EXT: 300 m²

Scale in metres. Indicative only. Dimensions are approximate. All information contained herein is gathered from sources we believe to be reliable. However, we cannot guarantee its accuracy and interested persons should rely on their own enquiries.

98 Cabbage Road, Ingleside

Scale in metres. Dimensions are approximate. All information contained herein is gathered from sources we believe to be reliable, however we cannot guarantee its accuracy and interested persons should rely on their own enquiries.