



Level 27/2705/350 William Street, Melbourne
FOR SALE

Light, space, and superb views in 'Art on the Park'

With a great position on the 27th floor of the luxury tower, Art on the Park complex, which is right next to the picturesque Flagstaff Gardens. This extra-large two bedroom corner apartment is a light-filled and contemporary property that promises stunning views of the surrounding city and is located near Queen Victoria Market, Melbourne Central shops, RMIT University, amazing CBD attractions, and Flagstaff Station.

Accommodation: Feel a sense of relaxation the second you step inside this exceptional apartment, which has phenomenal views to the south-east and north where you can marvel at the tall city buildings and even out to Port Phillip Bay.

Major highlights include a generous east-facing balcony, light-filled central living and meals, stone kitchen with full stainless-steel appliances including a dishwasher. The master bedroom has access to the balcony along with a mirrored built-in wardrobe and pristine ensuite. The second bedroom also has a mirrored built-in robe, gleaming bathroom and a European laundry.

Features

Built-In Robes
Air Conditioning



Mark Reuben
Principal - Mark Reuben Property
M: 0411 899 714
E: mark.reuben@smileelite.com



Mark Reuben

Principal - Mark Reuben Property

M: 0411 899 714

E: mark.reuben@smileelite.com

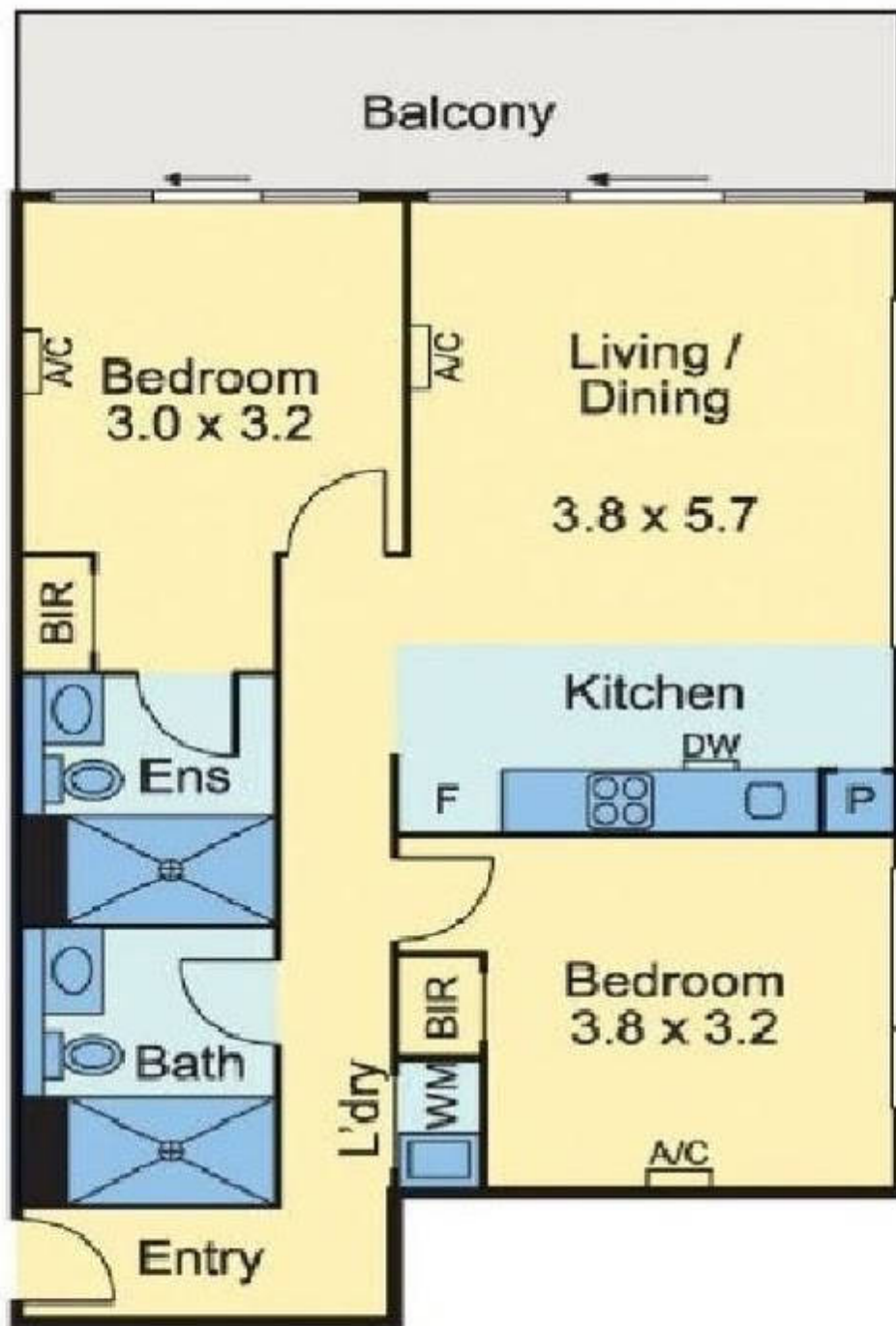

Scale in metres. Dimensions are approximate. All information contained herein is gathered from sources we believe to be reliable, however we cannot guarantee its accuracy and interested persons should rely on their own enquiries.