



425/17-19 Memorial Avenue, St Ives
FOR SALE



Spacious sun drenched two bedroom apartment

Situated in the ever-popular Lorealea Gardens complex, this immaculate two-bedroom apartment is great for growing families. With an ideal north-west facing aspect, this apartment is sun-drenched throughout the day and is ideally positioned close to local parks, shopping centres, and premium schools.

Features:

- Light interiors and leafy outlook
- Open plan living and dining area, providing a perfect blend of indoor and outdoor entertaining spaces
- Two generous sized bedrooms
- Great sized modern kitchen with ample storage
- Luxury resort style facilities, including a heated indoor lap pool, spa, sauna and gym
- LED downlights
- Split system air-conditioning
- Secure single car park

Absolutely ideal for young families or investors, this apartment offers exceptional value in this market.

Disclaimer: All information contained herein is obtained from property owners or third-party sources which we believe are reliable.

Features

1 Open Spaces For Vehicle
Air Conditioning



Lisa Luo

Associate - Amit Kumar Property

M: 0449 851 088

E: lisa.luo@smileelite.com



Amit Kumar

Principal - Amit Kumar Property

M: 0422 256 468

E: amit.kumar@smileelite.com



Lisa Luo

Associate - Amit Kumar Property

M: 0449 851 088

E: lisa.luo@smileelite.com



Amit Kumar

Principal - Amit Kumar Property

M: 0422 256 468

E: amit.kumar@smileelite.com

AMIT KUMAR

PROPERTY

425/17-19 Memorial Avenue, St Ives

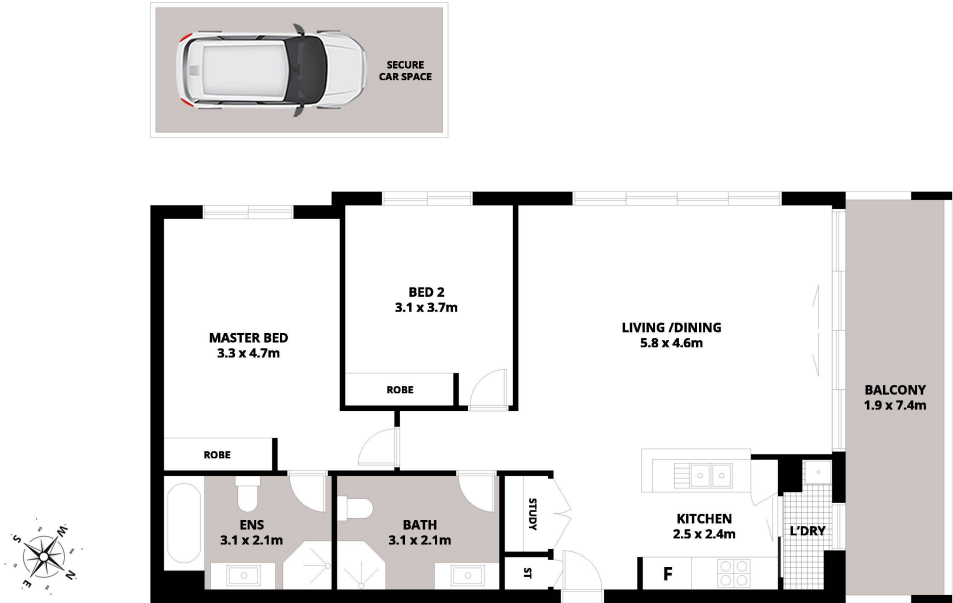

Scale in metres. Dimensions are approximate. All information contained herein is gathered from sources we believe to be reliable, however we cannot guarantee its accuracy and interested persons should rely on their own enquiries.

POWERED BY SMILE ELITE™
PROUD PARTNERS WITH SYDNEY COUNTRY LIVING

Scale in metres. Dimensions are approximate. All information contained herein is gathered from sources we believe to be reliable, however we cannot guarantee its accuracy and interested persons should rely on their own enquiries.