



13 Cape Vista Drive, Ewingsdale FOR SALE

Dream lifestyle property with income

Ideally located atop a lush green plateau in the upmarket and private enclave of Ewingsdale, this luxurious, boutique resort has five private and beautifully appointed villas, in addition to the three-bedroom primary residence which also offers a flexible floor plan allowing for a separate two-bedroom apartment to be utilised as a villa-number 6.

Secluded by tropical gardens, landscaped lawns, and a perfect northeast aspect, each villa features private decks with amazing outlooks, a high-end fit-out, a private ensuite and deck to relax on and reverse cycle air-conditioning.

Incredible, expansive views extend out over the town and surrounding Byron Bay and further along the coastline providing the absolute best direct line of vision to the iconic Cape Byron and its beautifully renowned Lighthouse. Spend hours gazing up and down the coastline watching the ever-changing colours of the sea and the sky.

Whisper quiet and with soothing, gentle breezes and swaying palm trees, going anywhere soon is not an option!

Features

7 Toilets
1 Ensuite
2 Living Areas
9 Open Spaces For Vehicles
Air Conditioning

Land size

5,935.00 Sqm



Karin Heller

Licensed Agent - Kim Jones Property

M: 0409 177 659

E: karin.heller@smileelite.com



Kim Jones

Principal - Kim Jones Property

M: 0414 629 924

E: kim.jones@smileelite.com



Karin Heller

Licensed Agent - Kim Jones Property

M: 0409 177 659

E: karin.heller@smileelite.com



Kim Jones

Principal - Kim Jones Property

M: 0414 629 924

E: kim.jones@smileelite.com

Floor Plan Disclaimer: Media Drive floor plans / site plans are intended as an approximate guide only. No representations or warranties of any nature are given.

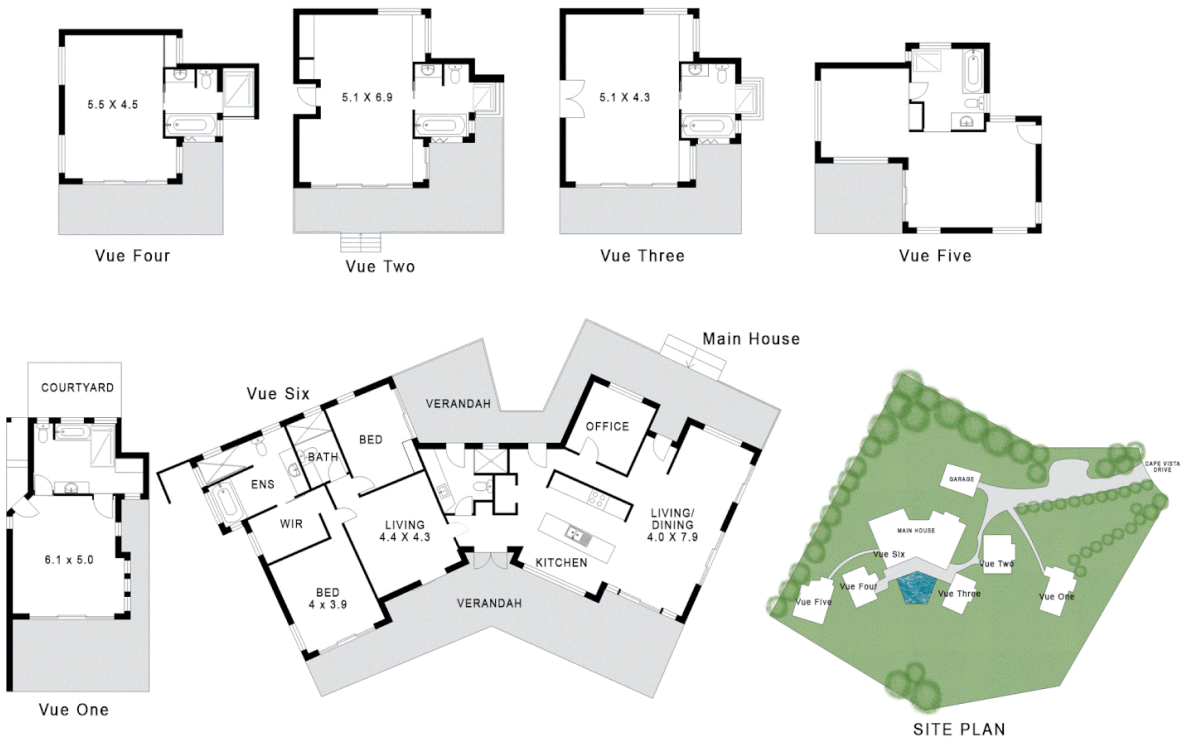

Scale in metres. Dimensions are approximate. All information contained herein is gathered from sources we believe to be reliable, however we cannot guarantee its accuracy and interested persons should rely on their own enquiries.