

9-11 Centennial Circuit, BYRON BAY FOR SALE



Exceptional large industrial investment opportunity

An unrivalled freehold investment in the heart of Byron Bay's Industrial and Arts Estate, offers astute buyers an exceptional opportunity to acquire premium industrial real estate only minutes to Byron Bay CBD. The magnitude of this commercial property delivers large scale business possibilities rarely available in this highly desirable location.

Comprising 2802sqm of clear span open floor space, the warehouse provides remarkable scope to incorporate various applications and layouts. Built from tilt slab construction the external walls reach a height of 6.24m rising to 10.10m at its peak, delivering exceptional space for a multitude of internal possibilities to create functional design fit for purpose.

Currently the warehouse encompasses two levels of executive office suites situated at the front of the building, totalling 297sqm on each level. Each floor comprises a mix of open plan workstations, separate offices and boardroom facilities, incorporating ducted air-conditioning, telephone and data cabling with extensive staff amenity including kitchenettes, toilets and on-site parking.

Features

Land size

3,862.00 Sqm



Karin Heller

Licensed Agent - Kim Jones Property

M: 0409 177 659

E: karin.heller@smileelite.com



Karin Heller

Licensed Agent - Kim Jones Property

M: 0409 177 659

E: karin.heller@smileelite.com

9-11 Centennial Circuit
BYRON BAY
Land Size 3,771m²

KIM JONES
PROPERTY

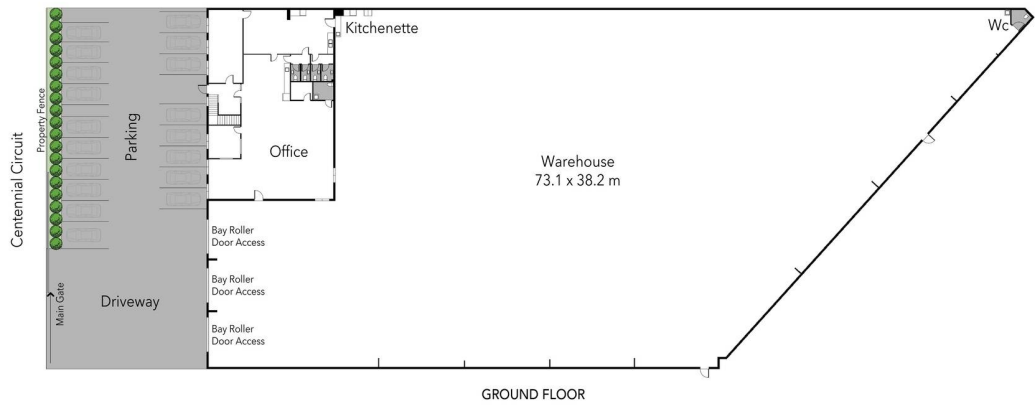

FLOOR AREA SIZES
Internal 3,031 m²
Parking Lot 433 m²
Total 3,464 m²

PROPERTY DETAILS

- 1	- 3	- 5
- 9	- 18	



Scale in metres. Dimensions are approximate. All information contained herein is gathered from sources we believe to be reliable, however we cannot guarantee its accuracy and interested persons should rely on their own enquiries.