



29 Oakley Avenue, East Lismore FOR SALE



Charm, character and convenience

A delightful East Lismore home

- Two bedrooms plus sleepout offer versatility and ample space
- High ceilings with ornate cornices & hardwood floors provide a timeless elegance
- A cute Art Deco style kitchen will inspire your creativity and passion for food
- Low maintenance, fully fenced yard offer a safe and secure space for play
- Conveniently situated close to schools, hospital and university

Ideally located, this cute East Lismore home offers charm, character & convenience

Features



Lyn Youngberry
Principal - Lyn Youngberry Property
M: 0411 507 209
E: lyn.youngberry@smileelite.com



Lyn Youngberry

Principal - Lyn Youngberry Property

M: 0411 507 209

E: lyn.youngberry@smileelite.com

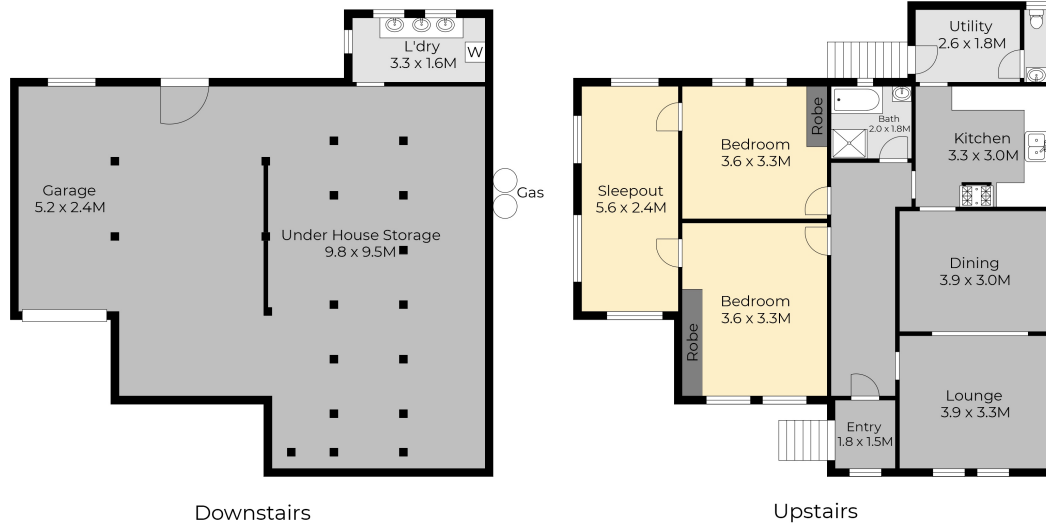

29 Oakley Avenue, East Lismore

Disclaimer: For illustrative purpose only Floor plan measurements, size, and scale are approximate we take no responsibility for omission and errors. Floor plan by maverick Studio www.maverickstudio.co.nz

Scale in metres. Dimensions are approximate. All information contained herein is gathered from sources we believe to be reliable, however we cannot guarantee its accuracy and interested persons should rely on their own enquiries.