



15 Philmont Way, MEADOW SPRINGS FOR SALE



****** Under Offer Well Below Average Days On Market **** Large Family Home with Opulent Street Appeal**

15 PHILMONT WAY, MEADOW SPRINGS

This Shelford Constructions built home, sits on a larger than average 589 sqm block. Recently renovated and freshly painted throughout, this home is not to be missed!

On entering the home, to the left is a large front lounge/theatre room for those family movie nights and to the right, a huge master bedroom with large walk-in wardrobe, newly renovated ensuite, new window treatments and new carpet. Then through to the open plan living you will appreciate the huge space offered here, with a large family room, a well-appointed and newly renovated kitchen. Boasting an abundance of bench top and cupboard space plus dining area and separate games room.

The three other bedrooms are also generous in size, all with built-in wardrobes. The family bathroom is equipped with a bath, vanity and shower. There is a separate toilet next to the renovated laundry which has a large four door linen cupboard, offering great storage and new fixtures and fittings throughout.

This home is complete with a seamless transition from the family/dining and games room to the outdoor area. Here you will find a pitched roofed patio, making a great entertaining space with a fantastic sense of openness. The gardens are low maintenance and fully reticulated to both front and rear.

Other features you are sure to love include:

- Evaporative air conditioning
- Gas bayonet to family room and theatre
- New LED lights throughout
- New kitchen benchtops, doors and drawers
- New oven and hob
- New carpets throughout
- New window treatments throughout
- Freshly painted throughout
- Grout to tiled areas professionally cleaned



Jan Holloway

Principal - Lewis Holloway Property

M: 0499 955 442

E: jan.holloway@smileelite.com

- NBN fibre to the premises

All of the above and so close to several quality public and private schools, public transport, Meadow Springs shopping centre, a sporting oval, the Meadow Springs Golf and Country Club. Beautiful beaches are only a short drive away, quick and easy freeway access to the CBD and just a short distance to the 2023 Lakelands Train Station. These superb features would surely put this home on your list of 'To View' properties.

Don't delay! To book your inspection, call Jan Holloway on 0499 955 442.

Disclaimer:

This information is for general information purposes only and is based on information provided by the Seller and may be subject to change. No warranty or representation is made as to its accuracy and interested parties should place no reliance on it and should make their own enquiries

Features

- 1 Ensuite
- 2 Open Spaces For Vehicles
- Air Conditioning

Land size

589.00 Sqm



Jan Holloway

Principal - Lewis Holloway Property

M: 0499 955 442

E: jan.holloway@smileelite.com

JAN HOLLOWAY
PROPERTY

15 PHILMONT WAY, MEADOW SPRINGS / 213 sqm

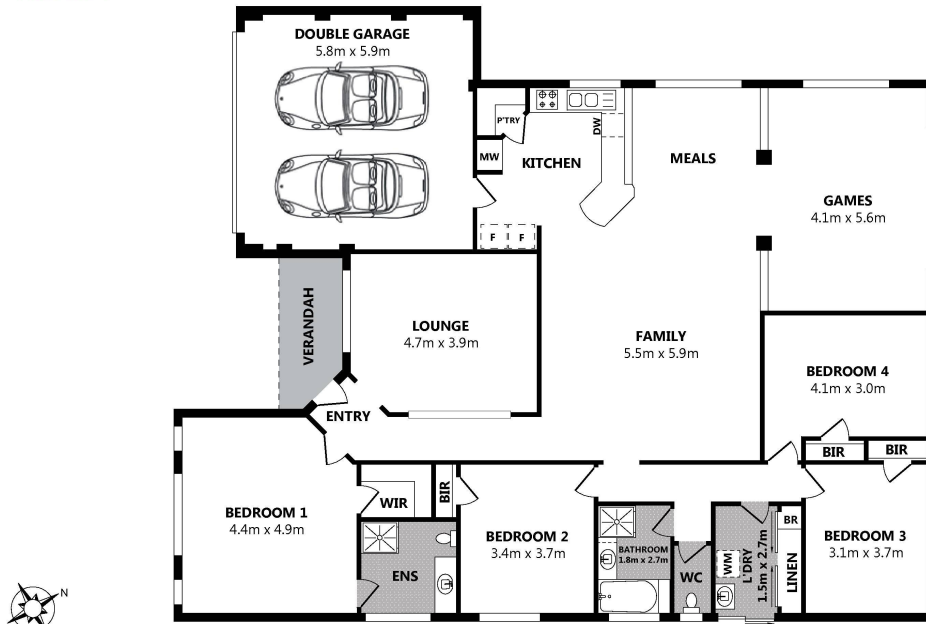

Scale in metres. Dimensions are approximate. All information contained herein is gathered from sources we believe to be reliable, however we cannot guarantee its accuracy and interested persons should rely on their own enquiries.

Powered by **SMILEELITE™**

Scale in metres. Dimensions are approximate. All information contained herein is gathered from sources we believe to be reliable, however we cannot guarantee its accuracy and interested persons should rely on their own enquiries.