



## 2A Darbal Place, GREENFIELDS FOR SALE



**Calling all first home buyers. A perfect opportunity presents! \*\* Home Open Cancelled \*\***

Lewis Holloway Property is proud to bring to market this fantastic low-maintenance home. An excellent opportunity for a first home buyer, investor, or downsizer.

This neat and tidy 3-bedroom, 1 bathroom brick and tile home, built in 1987, is situated on a 503 (approx.) square meter corner block and has side access and a driveway large enough to park a caravan/boat and cars.

The front garden is just beautiful, a haven for birds and local wildlife whilst the rear yard is very low maintenance with a covered alfresco area transitioning from the family room and a larger area through the laundry with three sheds, one a tool shed and other 2 approx. 3x2m in size plus a double gated entry providing a secure area large enough for a trailer.

The property has a formal living area to the front overlooking the beautiful gardens then moving into the home, opens into to a dining/family/kitchen. The three bedrooms are all a good size with built in robes and close in proximity to the bathroom, separate toilet, and laundry.

The kitchen has been renovated and boasts ample below bench cupboard space with plenty of work top areas and large space for a modern fridge/freezer, plus dishwasher. You will also find quality appliances including 4 ring electric induction hob with extractor hood and splashback behind.

Off the kitchen you will find a decent sized study which could become a 4th bedroom.

Some of the other features include:

- New hybrid laminate flooring to main living with carpet to lounge and bedrooms
- Split system air-conditioning to main living and master bedroom.
- Ceiling fans to the main living area and bedrooms one and two.
- Patios at side and rear of the property.
- Three sheds for extra storage.
- Side access.
- Solar Hot Water system
- Single carport with large workshop area which could very easily be made secure with an electric roller door.
- Neat and tidy, recently painted throughout and ready to move into.



**Jan Holloway**

Principal - Lewis Holloway Property

**M:** 0499 955 442

**E:** [jan.holloway@smileelite.com](mailto:jan.holloway@smileelite.com)

Positioned in a sought-after area of Greenfields, in Riverside Gardens and moments to Peel Health Campus, parklands, and schools this property won't be on the market long.

Disclaimer: This information is provided for general information purposes only and is based on information provided by the Seller. No warranty or representation is made as to its accuracy and interested parties should place no reliance on it and should make their own independent enquiries.

### Features

Built-In Robes

Study

1 Carport

Air Conditioning

### Land size

503.00 Sqm



**Jan Holloway**

Principal - Lewis Holloway Property

**M:** 0499 955 442

**E:** [jan.holloway@smileelite.com](mailto:jan.holloway@smileelite.com)

**LEWIS HOLLOWAY**  
PROPERTY

2A Darbal Place, Greendfields

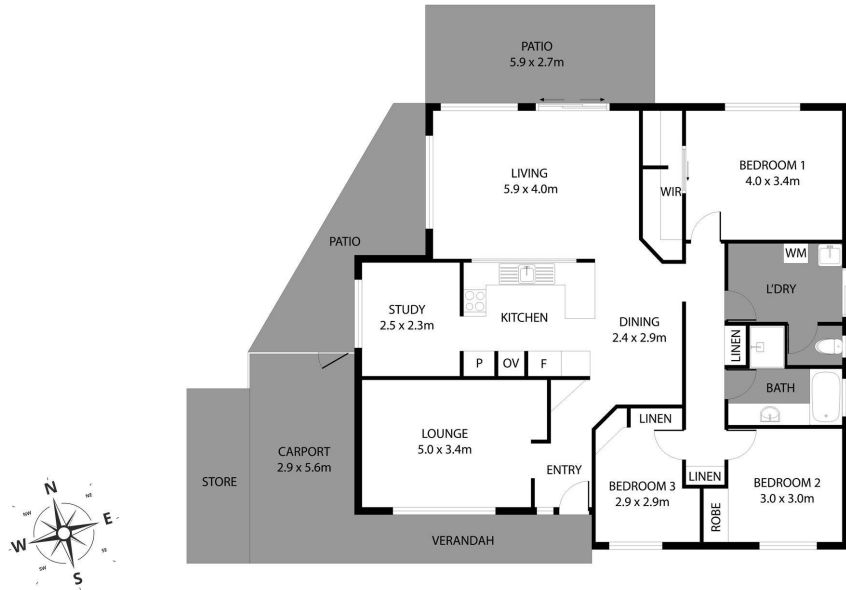

O'no'k'j b'p'z' q' b'q' k'p' b' m' d' q' 'p' - l' l' d' g' 'q' k' l' k' q' k' b' e' b' k' f' p' q' b' a' d' j' p' r' d' t' p' b' \_ b' i' s' b' d' \_ b' a' i' p' \_ l' d' e' t' b' a' b' o' t' b' 'k' k' i' q' d' 'o' k' q' b' f' p' ' r' o' v' 'k' a' k' q' d' p' a' n' b' a' i' k' p' p' e' i' r' i' a' d' o' v' l' k' q' e' b' i' t' k' b' i' n' r' k' i' z' p'

POWERED BY SMILE ELITE™  
PROUD PARTNERS WITH SYDNEY COUNTRY LIVING

Scale in metres. Dimensions are approximate. All information contained herein is gathered from sources we believe to be reliable, however we cannot guarantee its accuracy and interested persons should rely on their own enquiries.