



13B Mippi Road, HALLS HEAD FOR SALE



Walk to the beach, superb premium elevated location!

Beach lovers will adore this cute elevated four-bedroom home, located approximately 250m from the gorgeous Blue Bay Beach.

This four-bedroom, two-bathroom home is definitely worth a look, it's immaculately presented and offers low maintenance, lock-up and leave, with plenty of parking at the front of the home.

Property features:

- Four bedrooms
- 510 sqm elevated block
- Natural decor
- Evaporative air-conditioning
- Ensuite to the master
- Main bathroom
- 1.6Kw solar system
- Insulated roof
- Reticulated lawns via submersible bore
- Shady outdoor area with pergola

This property is in close proximity to Todd's Cafe, Doddi's Beach and of course fabulous Blue Bay Beach, and not too far from Mandurah's town center.

Disclaimer: This information is provided for general information purposes only and is based on information provided by the Seller and may be subject to change. No warranty or representation is made as to its accuracy and interested parties should place no reliance on it and should make their own independent inquiries.

Features

- 2 Toilets
- Built-In Robes
- 1 Ensuite
- 1 Living Area
- 1 Open Spaces For Vehicle
- Air Conditioning



Jan Holloway

Principal - Lewis Holloway Property

M: 0499 955 442

E: jan.holloway@smileelite.com

Land size

510.00 Sqm



Jan Holloway

Principal - Lewis Holloway Property

M: 0499 955 442

E: jan.holloway@smileelite.com

LEWIS HOLLOWAY
PROPERTY

13B Mippi Road, Hals Head/132.4m²

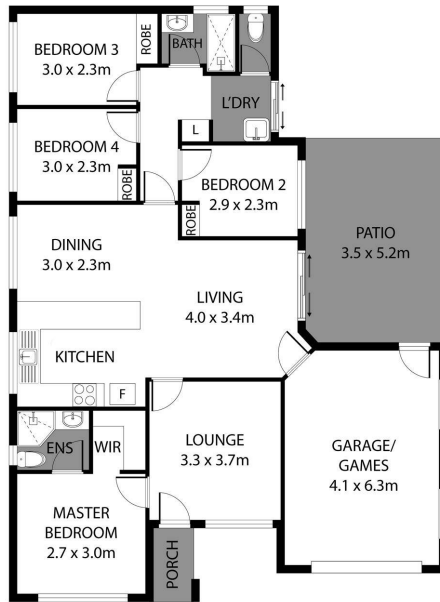

Scale in metres. Dimensions are approximate. All information contained herein is gathered from sources we believe to be reliable, however we cannot guarantee its accuracy and interested persons should rely on their own enquiries.

POWERED BY SMILE ELITE™
PROUD PARTNERS WITH SYDNEY COUNTRY LIVING

Scale in metres. Dimensions are approximate. All information contained herein is gathered from sources we believe to be reliable, however we cannot guarantee its accuracy and interested persons should rely on their own enquiries.