



4/22 Orara Street, Urunga FOR SALE



Where the River Meets the Sea!

Welcome to one of the best hidden gems on the North Coast - the beautiful beachside township of Urunga.

This lovely, well-presented 2-bedroom apartment is perfectly located within an easy, flat walk to the shopping centre, cafés, and the iconic boardwalk where the river meets the sea.

This 68sqm apartment features two spacious bedrooms, each with built-in wardrobes. The combined bathroom and laundry area add convenience to your daily routine, while the generous open-plan living and dining room provides a perfect setting for relaxation and entertainment.

Indulge in the warmth of the original yet well-maintained kitchen, complete with abundant cupboard space for all your culinary essentials.

Ceiling fans are available throughout the apartment, although they are rarely needed due to the stunning sea breezes that Urunga and this apartment enjoy.

Relax and enjoy access to your own private balcony from the main bedroom.

For convenience and parking, there is a single carport and a secure lock-up storage shed.

Adjoining the complex is the ever-popular Urunga Bowling Club, offering easy access to dining options and leisure activities.

Strata fees are \$1,850 per year or \$462.50 per quarter.

Quality locations like this don't come up often, so if you're looking for an excellent investment with a tenant in occupation or your future amazing address, there's none better than this!

Disclaimer: All information contained herein is obtained from property owners or third-party sources which we believe are reliable. We have no reason to doubt its accuracy, however we cannot guarantee it. All interested person/s should rely on their own enquiries.

Features



Brett Weick

Principal - Brett Weick Property

M: 0448 679 697

E: brett.weick@smileelite.com

Land size

934.00 Sqm

Estimated Rent

\$400.00



Brett Weick

Principal - Brett Weick Property

M: 0448 679 697

E: brett.weick@smileelite.com

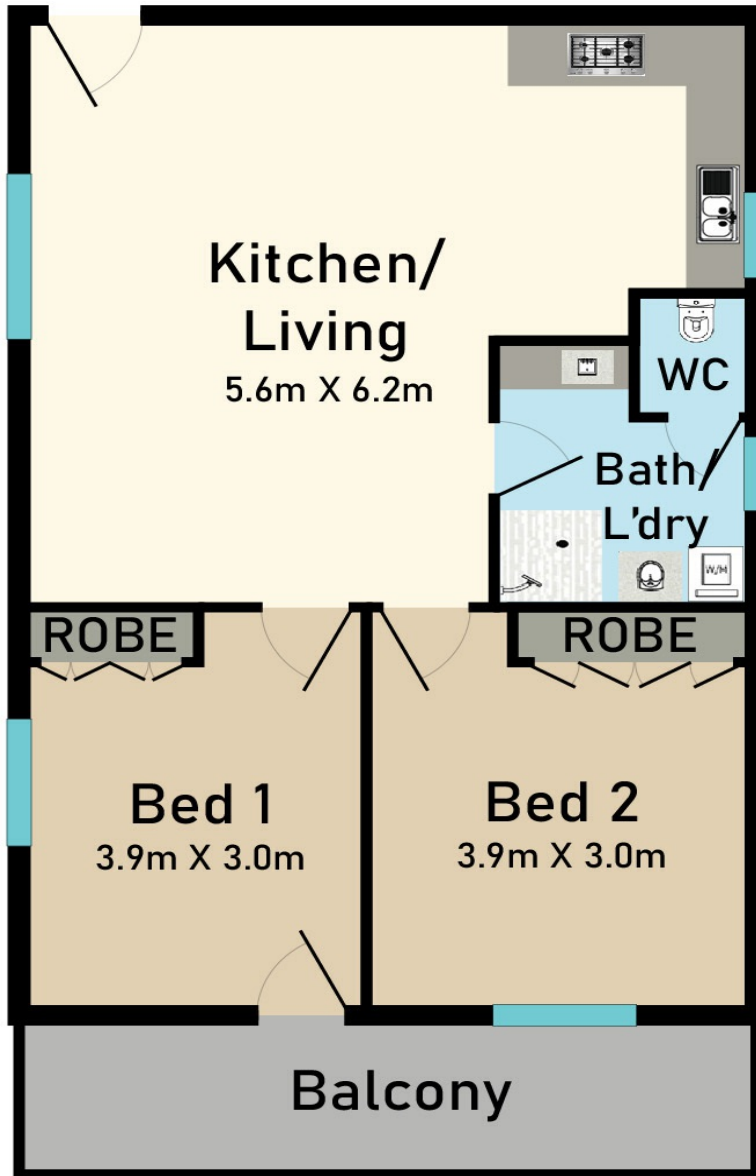

Unit 4/22 Orara Street, Urunga, NSW 2455

* Dimensions are approximate and for illustrative purposes only

